

ABOVE IT ALL. THE SUMMIT.

FUTURE PERFECT



TAKE THE LONG VIEW AT THE SUMMIT.

The Summit has established the benchmark for master-planned luxury home communities in the Texas Hill Country. Its views, its access and convenience, and the uncommon aesthetic of long-range vistas within the convenience of the City make The Summit of Kerrville a special—and limited—opportunity.

Summit Phase XII is now open, with a range of view lots and homesites for sale. View it from a distance, and then come view it up close. The Summit will broaden your perspective on value.

The Summit. Future perfect.



830.257.8989 ▪ 800.230.1219
www.integritygrouptexas.com



THE SUMMIT

THE SUMMIT—LOT MAP

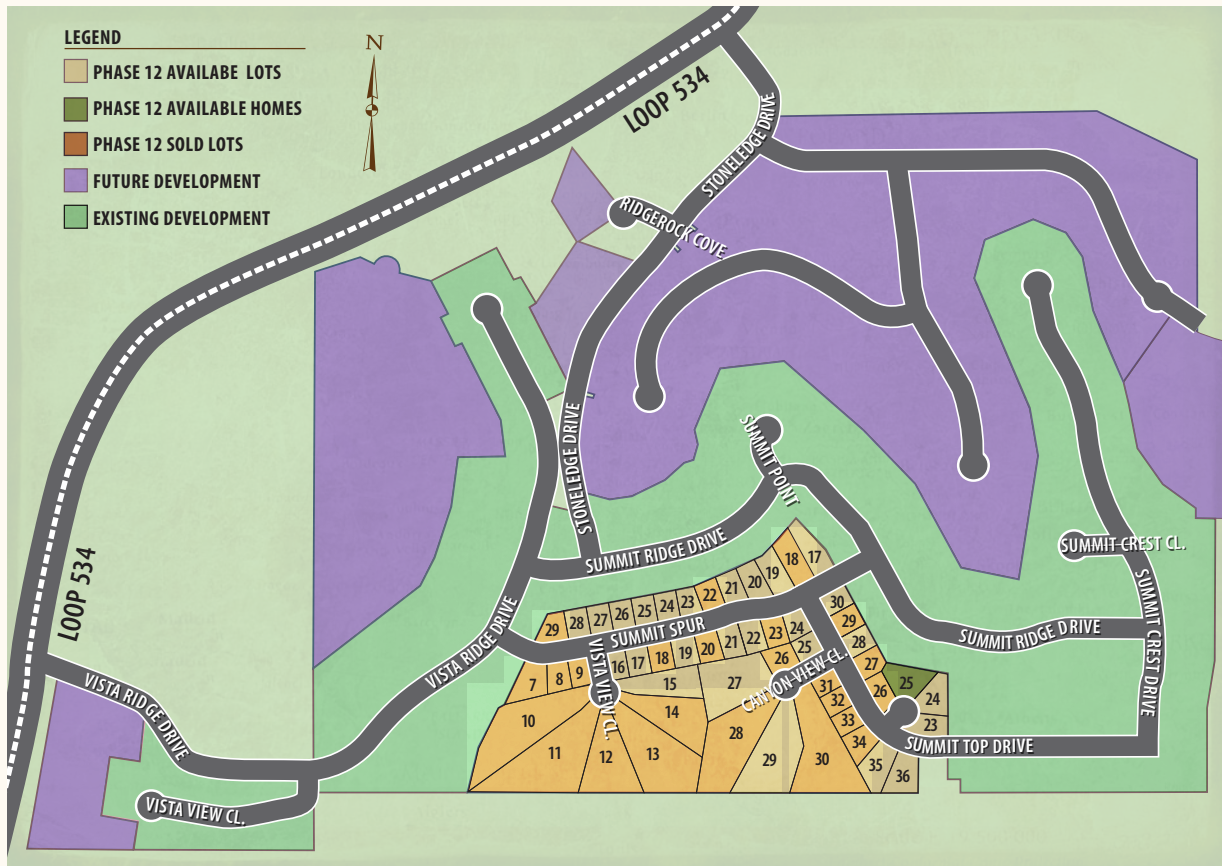

- **Established Neighborhood phased in from the 1990's through today**
- **Long-range, stunning views**
- **Lighted streets**
- **Convenience to town**
- **Underground utilities**
- **Kerrville municipal fire, police, and EMS protection**

Map revised: June 23, 2008. Lot status is subject to change without notice. Please call us for the latest information.



Andy Phillips—
Owner/Broker 830.739.8989
Travis Roberson—
Sales Professional 830.377.0005

Gloria Louk—
Sales Professional 830.285.1037
Bradley Morris—
Associate Broker 210.200.9599



1008 Sidney Baker South
Kerrville, Texas 78028
830.257.8989 ▪ **800.230.1219**
www.integritygrouptexas.com



©2008 Integrity Group Texas